

3511 - 4558 BH VOP

CROSS SECTION OF INSTALLED SEAL

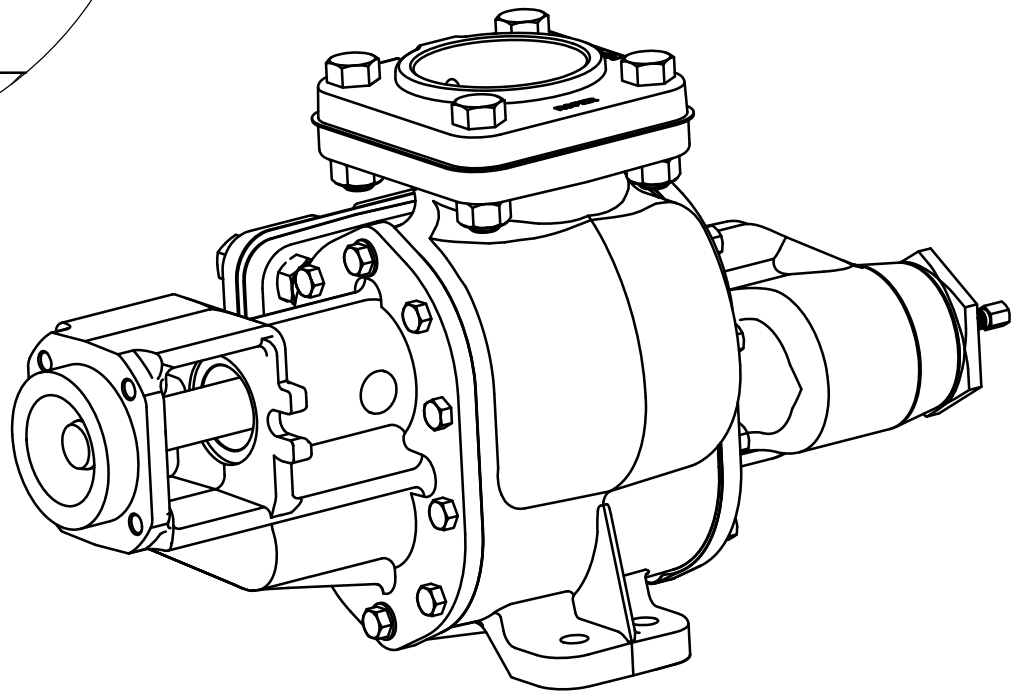
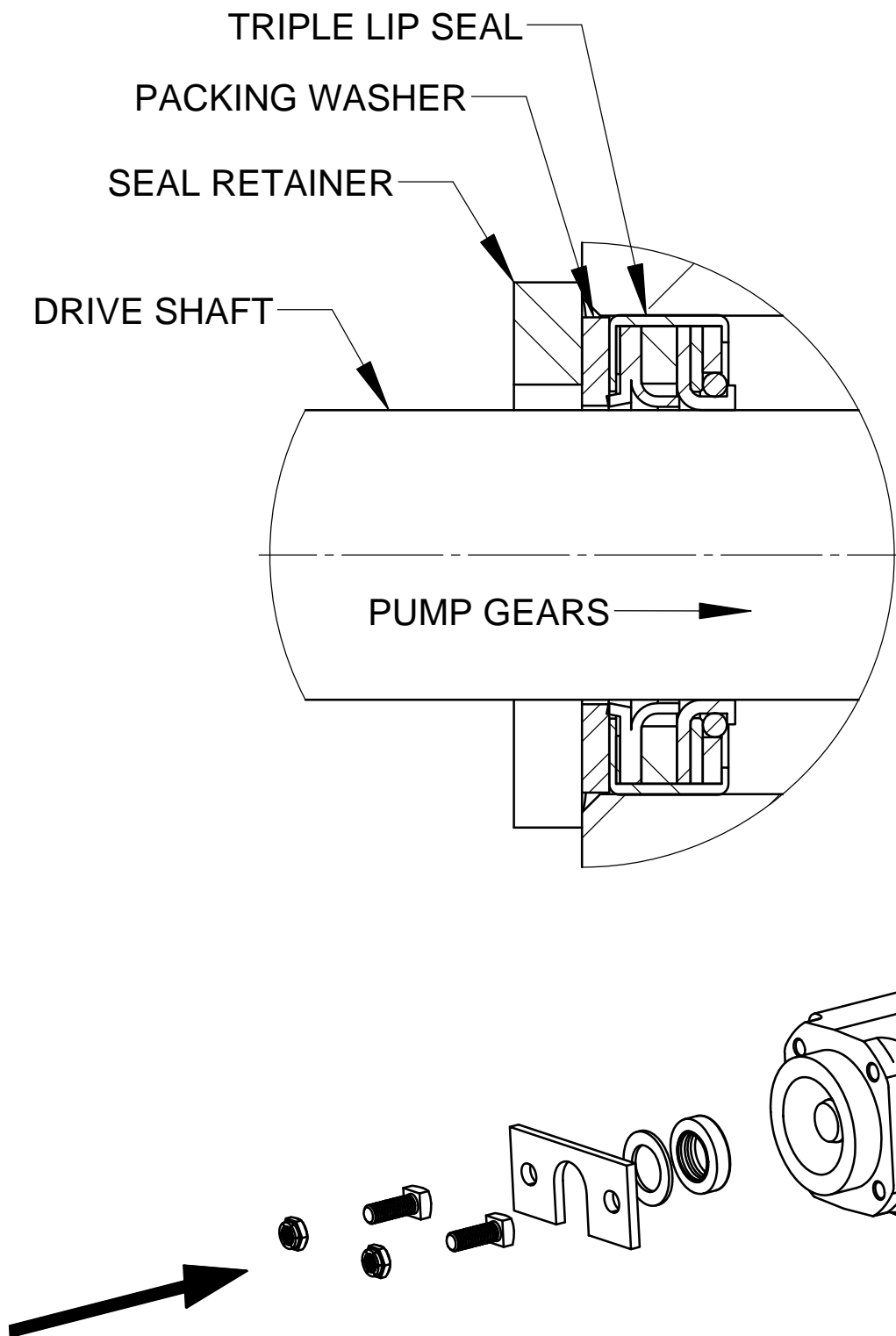

INSTALLATION OF TRIPLE LIP SEAL

1. It is very important the triple lip seal is not installed in such a way that it would have to slide over any retaining ring grooves. Use a small file or stone to break sharp edges of drive shaft keyway that will be under pump drive gear.
2. Fully assemble pump with the exception of the triple lip seal. Lubricate drive end of drive shaft and triple lip seal with a light oil. Slide triple lip seal over shaft with two lips facing toward pump gears. Gently push seal past tapered area of shaft and down to front of seal chamber. Press triple lip seal into bore until back side is flush with face of seal chamber. Take care to use a tool that will not damage or distort seal casing. Install one packing washer. Secure seal retainer in place.